

Better  
city living.

mift

Introducing **mlift**, an exclusive and refined line of elevator systems.

**mlift** brings human alchemy and sophisticated skill together to create elevators with subtle elegance and timeless design.

Simplicity in form and function is what makes **mlift** a level above the rest.

|   |                |
|---|----------------|
| <b>Product Presentation</b>                   | <b>04 - 21</b> |
| The Lift                                      | 05             |
| Cabin Design                                  | 07             |
| Car Operating Panel                           | 13             |
| Hall Operating Panel                          | 15             |
| Handrails                                     | 17             |
| Ceilings and Lights                           | 19             |
| Floors  | 21             |
| <b>Product Information and Specifications</b> | <b>22 - 34</b> |
| Product Specifications                        | 24             |
| Colors, Materials and Surfaces                | 26             |
| Landing Door                                  | 28             |
| Safety Curtain                                | 29             |
| Car and Hall Operating Panels                 | 30             |
| Standard Features                             | 32             |
| Optional Features                             | 34             |
| <b>Technical Specifications</b>               | <b>35 - 42</b> |
| Passenger Lifts MRL - Machine Roomless        | 36             |
| Passenger Lifts MR - with Machine Room        | 38             |
| Freight Lifts MRL - Machine Roomless          | 40             |
| Freight Lifts MR - with Machine Room          | 42             |



## mlift A new take on elevator travel

mlift is all about intelligent and sleek cabin design with excellent quality performance motors and drives.

Clean design, compactness and energy-efficiency. mlift provides premium quality materials and carefully executed solutions which guarantee the longevity and uniqueness of its products.

mlift also allows you to create your own elevator cabin with a variety of delicately selected, matching materials, colors and surface finishes. Its harmonized accessories meet the high standards of architecture, function, technology and design.

Design, manufacture, installation and service are all carried out according to strict safety and quality requirements of EN81.



Light green with recommended signalization and accessories.

## Quality Pure craftsmanship with timeless value

Our cabins are custom built and hand finished by our craftsmen. The cabin walls and edges are cut using laser technology to guarantee a seamless transition between materials and surfaces.

Each cabin is assembled by hand from start to finish in compliance with the requirements of EN81 standards.

Timeless elegance, five brilliant colors, over twenty color combinations and the use of superior quality materials alongside attractive and intelligent design.



Traffic White with recommended signalization and accessories.



Telegrey 4 with recommended accessories.

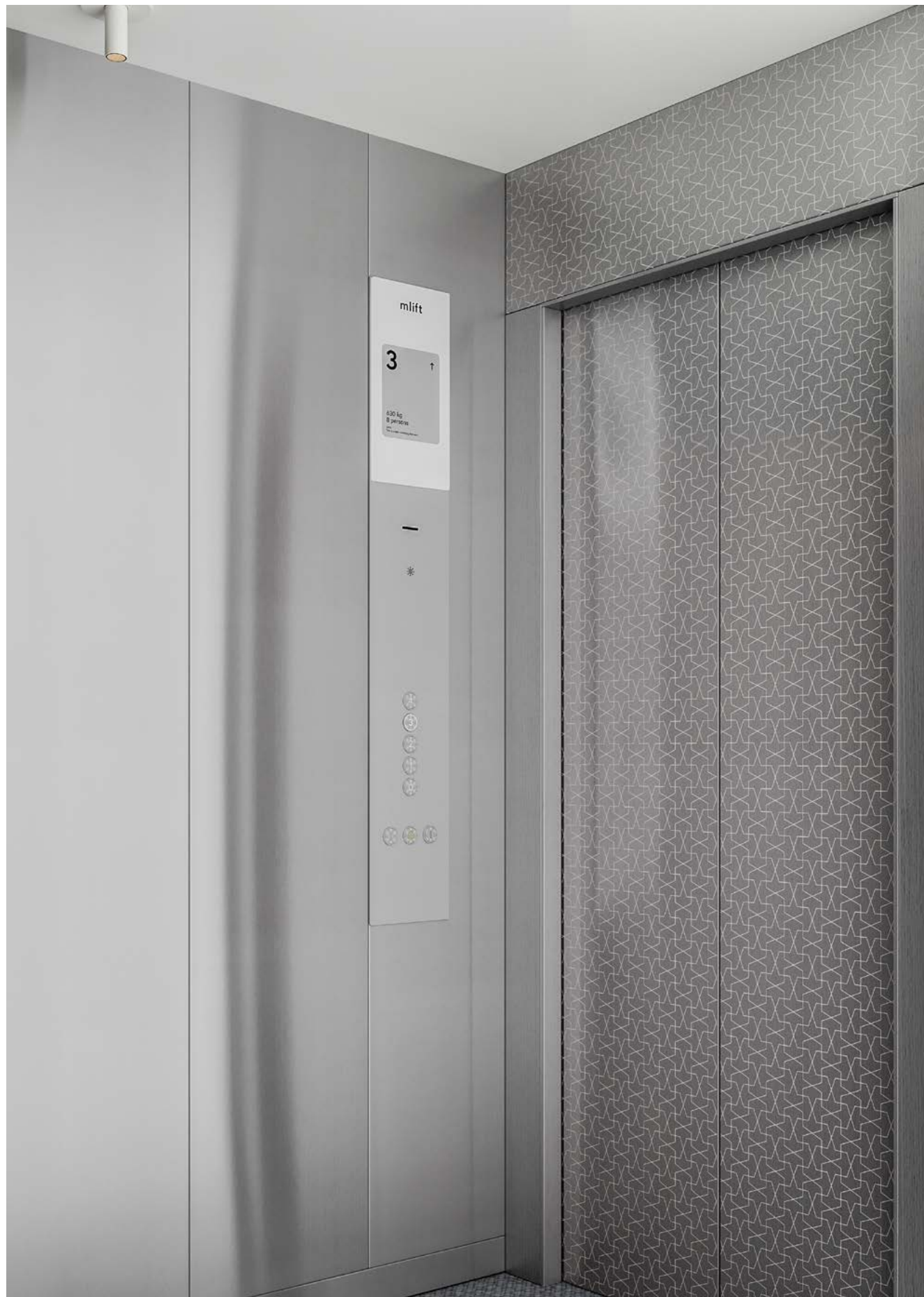

Plain stainless steel with recommended signalization and accessories.



Gold stainless steel with recommended signalization and accessories.



## Design User-friendly and elegantly simple

The Car Operating Panel is created and designed to be easy to use for passengers by means of simple design, arrangement of information and material choice.

Materials and surface finishes such as plain stainless steel, glossy acrylic glass, simple design buttons with LED lighting technology and high resolution TFT display, create a sense of balance and simplicity.

mlift's Car Operating Panel has a thickness of only 3mm, making it fit in and integrate seamlessly into your cabin.

The Car Operating Panel's upper faceplate is available in either black or white while the lower faceplate is available in either gold or plain stainless steel offering a wider choice for color matching.





mlift Hall Operating Panel in plain stainless steel with TFT display - black.



mlift Hall Operating Panel in gold stainless steel with TFT display - white.

## Form

Slim and perfect,  
down to  
the last detail

### Hall Operating Panel

The Hall Operating Panel is not only discreet on any wall, but also supports plenty of functions through its different designs. Its form blends innovation, mobility and intelligent building flexibility.

With a fine thickness of 2mm, mlift's Hall Operating Panel gives a minimalist feeling through its precise thin finishing and streamlined shape.

The panel is available in four different designs to accommodate for individual operations.

1. Stainless steel faceplate.
2. Stainless steel faceplate with TFT display.
3. Stainless steel faceplate with dual TFT display.

The Hall Operating Panel's upper faceplate is also available in either black or white while the lower faceplate is available in either gold or plain stainless steel offering a wider choice for color matching.



Plain stainless steel handrail - square variant.



Gold stainless steel handrail - square variant.



Plain stainless steel handrail - round variant.



Gold stainless steel handrail - round variant.

## Grip

Pure ergonomics  
with superb  
ride comfort

### Handrails

Solid grips within easy reach.

The handrails consist of clean geometric shapes that further create visual balance inside the cabin.

Every detail in the handrail combines simplicity of form with practicality of materials. The solid feel of stainless steel and its ergonomic build allow for comfortable and safe grip.

Placed on the rear wall of the cabin, it is perfect for additional stability and support for passengers.

The handrails are available in two different designs and two different color finishes to match its cabins:

1. Round 38 mm bar - available in gold or plain stainless steel.
2. Square 40 mm bar - available in gold or plain stainless steel.



Round movable spotlights - available in black or white.

## Luminosity

Where you need it,  
how you need it

Seeing well is feeling well.

mlift presents two individual and carefully thought-out ceiling lighting systems to complement the ambiance of your cabin.

Linear lighting consisting of two narrow bars extending from one side wall to the other for even spread of light inside the cabin.

Round lighting consisting of two movable spotlights positioned facing the back wall. Each spotlight can either be left inside its socket or pulled out and directed towards any direction.

mlift also provides two optional ceiling colors for its cabins.

1. Signal Black
2. Signal White

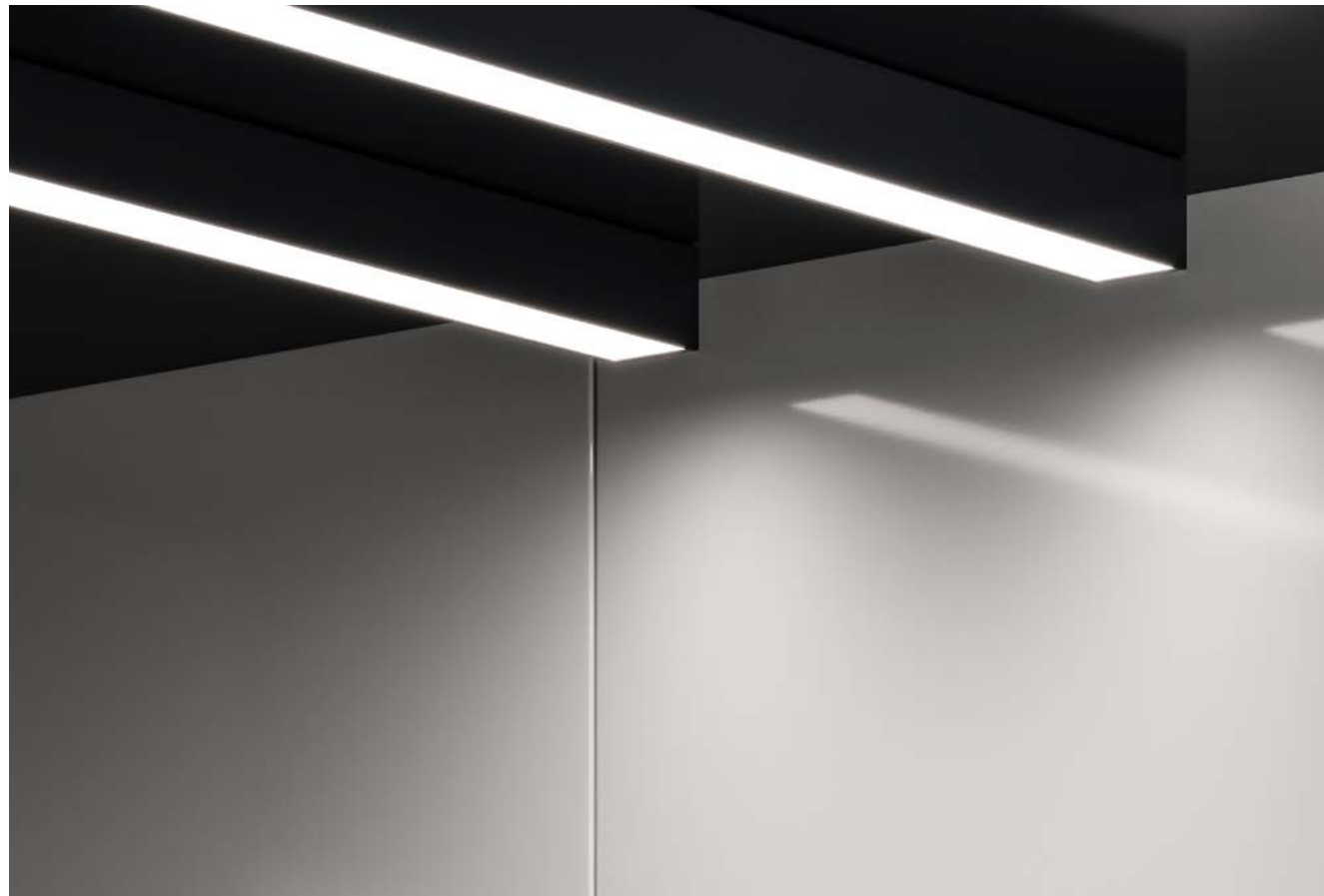

Linear narrow bars - available in black or white.

## Texture Minimalist with choices of tonality

The final layer that adds a boost to your cabin.

mlift introduces vinyl floors influenced by natural sisal rugs, but with a soft, structured and durable feel. Both vinyls have a fine pattern and a smooth, weavy feel.

The two floor mats are specifically selected to blend with all other elements inside the cabin - for a balanced overall cabin look.

Both mats are weaved with folded PVC yarn and are available in the following tones.

1. Plain Steel
2. Plain Black



Floor mat in Plain Steel.



Floor mat in Plain Black.

## Product Information and Specifications

| Detail  | Description  |
|---|--|
| Car doors, car walls, transom panel and front return panels | Stainless steel sheet with hairline finishing in plain or gold.<br>Plain or painted steel sheet optional in RAL 6021, 7047 and 9016.   |
| Accents for car doors and transom panel (optional)          | Engraved stainless steel in plain or in gold.<br>Available in two geometric variants.  |
| Ceiling   | Stainless steel with hairline finishing in plain or gold.<br>Painted steel sheet in RAL 9003 or RAL 9004.  |
| Floor   | Vinyl in plain black or steel.<br>22mm thickness floor reservation - pending client customization.   |
| Kickplate   | Same color as cabin walls.   |
| Lighting  | Dual strips, indirect, glare-free. Filter panel and light frame in acrylic glass - milky white.<br>Twin spotlights, direct, glare-free. Orientable, each spotlight can be retrieved and directed towards any direction inside the cabin.   |
| Light   | LED - natural white.   |
| Mirror (optional)   | Mirror glass with splinter protection film. Centered strip positioned on the rear wall and covering the car height. Mirror edges ground & polished - Inset Flush.  |
| Handrail  | Round - Ø 38mm bar made from stainless steel with hairline finishing in plain or gold. Handrail holder and handrail ends in stainless steel with hairline finishing. Handrail is placed on either the rear or side wall at 900mm from the ground.<br>Square - 40mm bar made from stainless steel with hairline finishing in plain or gold. Handrail holder and handrail ends in stainless steel with hairline finishing. Handrail is placed on either the rear or side wall at 900mm from the ground.  |
| Car Operating Panel   | Stainless steel with hairline finishing in plain or gold, positioned suitable for the handicapped. Concealed attachment with a thickness of 3mm. Information panel in black acrylic glass. Display in high resolution TFT - black background, white information. Emergency messages in red. Short travel buttons in stainless steel, call acceptance in white or yellow LED, symbols in yellow.<br>Stainless steel with hairline finishing in plain or gold, positioned suitable for the handicapped. Concealed attachment with a thickness of 3mm. Information panel in white acrylic glass. Display in high resolution TFT - white background, black information. Emergency messages in red. Short travel buttons in stainless steel, call acceptance in white or yellow LED, symbols in yellow. |
| Doors   | Telescopic opening - left or right opening option.<br>Central opening.   |

| Detail                  | Description  |
|-------------------------|--|
| Jambs and landing doors | Stainless steel sheets with hairline finishing in plain.<br>Plain or spray painted single color optional in RAL 7024, 7044, 7047 and 9016.   |
| Landing Operating Panel | Stainless steel with hairline finishing in plain or gold. Concealed attachment with a thickness of 2mm. Short travel buttons in stainless steel, call acceptance in white or yellow LED. Collective single button control.<br>Stainless steel with hairline finishing in plain or gold. Concealed attachment with a thickness of 2mm. Information panel in black acrylic glass. Display in high resolution TFT - black background, white information. Short travel buttons in stainless steel, call acceptance in white or yellow LED.<br>Stainless steel with hairline finishing in plain or gold. Concealed attachment with a thickness of 2mm. Information panel in white acrylic glass. Display in high resolution TFT - white background, black information. Short travel buttons in stainless steel, call acceptance in white or yellow LED.<br>Stainless steel with hairline finishing in plain or gold. Concealed attachment with a thickness of 2mm. Information panel in black acrylic glass. Dual display in high resolution TFT - black background, white information. Short travel buttons in stainless steel, call acceptance in white or yellow LED.<br>Stainless steel with hairline finishing in plain or gold. Concealed attachment with a thickness of 2mm. Information panel in white acrylic glass. Dual display in high resolution TFT - white background, black information. Short travel buttons in stainless steel, call acceptance in white or yellow LED. |

# Colors, Materials and Surfaces

\* RAL colors represented below are close approximations of the actual finished product tones and are used for reference consideration.

## Car doors, car walls, transom panel and front return panels



RAL 6021 - Light Green



RAL 7047 - Telegrey 4



Plain stainless steel - hairline.



Gold stainless steel - hairline.

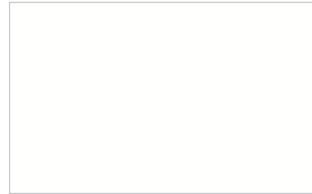

RAL 9016 - Traffic White

## Doors & transom panel

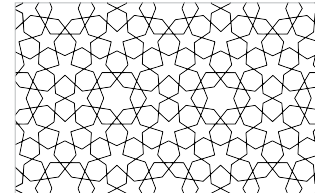

Geometric 1

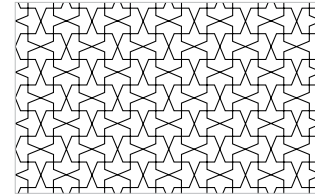

Geometric 2

## Jams and landing doors



RAL 7047 - Telegrey 4



RAL 7044 - Silk Grey

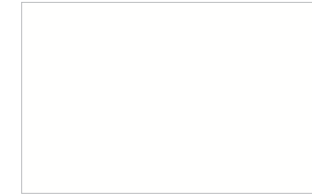

RAL 9016 - Traffic White



RAL 7024 - Graphite Grey

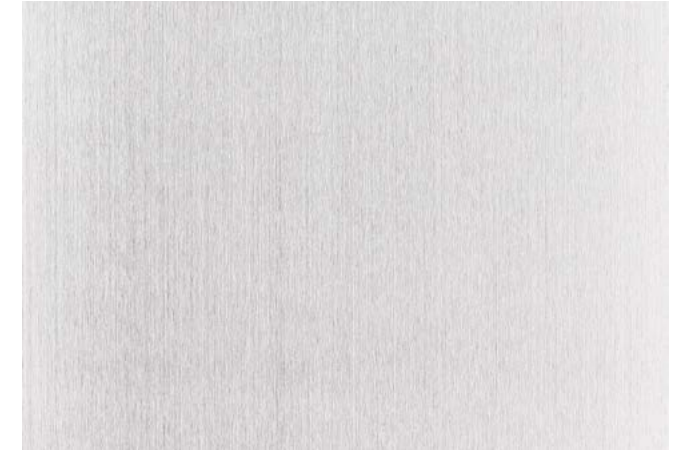

Plain stainless steel - hairline.

## Ceiling and lights



Dual steel light bars - black ceiling and lights variant.



Dual steel light bars - white ceiling and lights variant.



Round stainless steel spotlight - black variant.



Round stainless steel spotlight - white variant.

## Handrails



Plain stainless steel handrail - round variant.



Gold stainless steel handrail - round variant.



Plain stainless steel handrail - square variant.



Gold stainless steel handrail - square variant.

## Flooring



Vinyl floor mat in Plain Black.

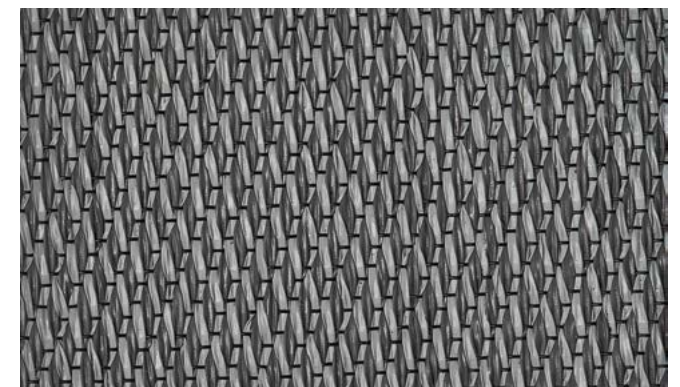

Vinyl floor mat in Plain Steel.



Landing door in stainless steel variant with hairline finish.

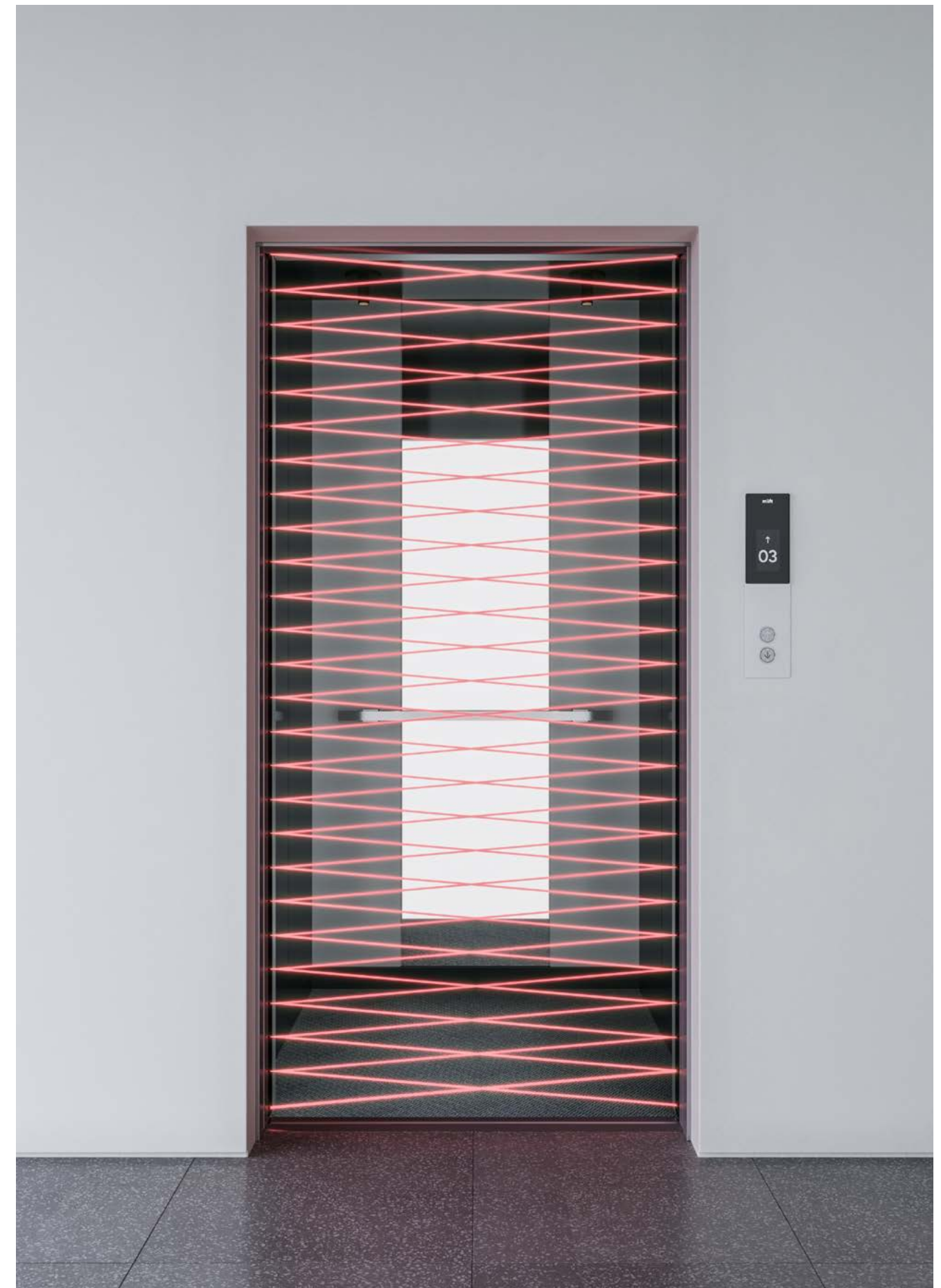

Safety curtain covering the full height of the door opening to detect passengers or objects.



# Car & Hall Operating Panels

## Car Operating Panel

| Type                             | Application   | Remarks   |
|----------------------------------|---|---|
| Location                         | Side wall.  | First button starts at 900mm from ground level. Faceplate starting width 200mm. Installation on the right side for CO doors and on the closing side for 2S doors. |
| Faceplate                        | Stainless steel with hairline finishing in plain or gold.         | Same as above.  |
|                                  | Black acrylic glass. White silkscreen.                            | Same as above.  |
|                                  | White acrylic glass. Black silkscreen.                            | Same as above.  |
| Direction and position indicator | High resolution TFT display, black background, white information. | Same as above.  |
|                                  | High resolution TFT display, white background, black information. | Same as above.  |
| No. of Stops                     | From 2 to 34. arrangement of buttons vary from 1 to 5 columns.    | Same as above.  |

## Hall Operating Panel - Single

| Type                             | Application   | Remarks   |
|----------------------------------|---|---|
| Application                      | 1 set.  | Face plate w 100mm x h 305mm<br>One or two call push button/ s.       |
|                                  |   | Face plate w 100mm x h 400mm<br>Up or down arrow push button.         |
|                                  |   | Face plate w 100mm x h 400mm<br>Two push buttons for full collective. |
| Faceplate                        | Stainless steel with hairline finishing in plain or gold.         | Same as above.  |
|                                  | Black acrylic glass. White silkscreen.                            | Same as above.  |
|                                  | White acrylic glass. Black silkscreen.                            | Same as above.  |
| Direction and position indicator | No display.   | Face plate w 100mm x h 305mm<br>One or two call push button/ s.       |
|                                  | High resolution TFT display, black background, white information. | Face plate w 100mm x h 400mm<br>Up or down arrow push button.         |
|                                  | High resolution TFT display, black background, white information. | Face plate w 100mm x h 400mm<br>Two push buttons for full collective. |

| Type    | Application   | Remarks   |
|---------|---|---|
|         | High resolution TFT display, white background, black information.       | Face plate w 100mm x h 400mm<br>Up or down arrow push button.         |
|         | High resolution TFT display, white background, black information.       | Face plate w 100mm x h 400mm<br>Two push buttons for full collective. |
| Buttons | Flat round buttons in stainless steel. response LED in white or yellow. | Same as above.  |

## Hall Operating Panel - Duplex

| Type                             | Application   | Remarks  |
|----------------------------------|---|--|
| Application                      | 1 set - 2 cars.   | Face plate w 180mm x h 400mm<br>Up and down buttons for full collective. |
| Faceplate                        | Stainless steel with hairline finishing in plain or gold.               | Same as above.   |
|                                  | Black acrylic glass. White silkscreen.                                  | Same as above.   |
|                                  | White acrylic glass. Black silkscreen.                                  | Same as above.   |
| Direction and position indicator | High resolution TFT display, black background, white information.       | Same as above.   |
|                                  | High resolution TFT display, white background, black information.       | Same as above.   |
| Buttons                          | Flat round buttons in stainless steel. Response LED in white or yellow. | Same as above.   |

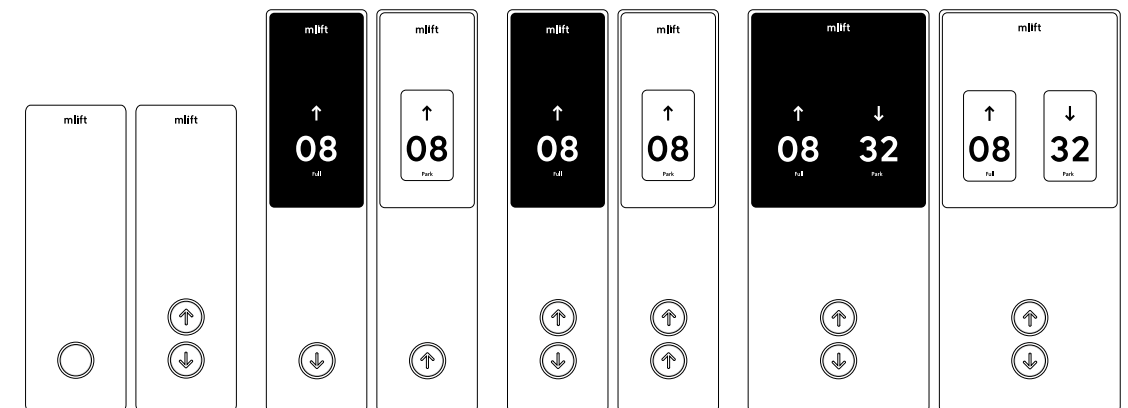

Above: Visual representation of Hall Operating Panel variants.

| Standard Features                      | Description   |
|--|---|
| VVVF Drive                             | The rotating speed of the motor can be precisely adjusted in order to get a smoother speed curve during lift start, travel and stop.  |
| VVVF Door Operator                     | VVVF inverter technology is applied to control the elevator doors with a high-speed switching device and a door motor controlled by a microprocessor, displaying steady and high performance at all times and providing efficient and sensitive door open/close operations. |
| Automatic Bypass                       | A full car will bypass hall calls in order to maintain maximum operating efficiency.  |
| Automatic Door-Open Time Adjustment    | Door opening times are automatically adjusted according to whether the stop was called from the floor or the car.   |
| Reopen with Hall Button                | While the doors are closing, they can be reopened by pressing the hall button.  |
| Fast Door Shutting                     | Pushing down the door-shut button on the control panel will immediately shut the car doors as soon as they open.  |
| False Call Canceling – Car Button Type | If the wrong floor button is pressed, it can be cancelled by pressing the same call button again.   |
| Safety Curtain                         | Full door height protection system, which utilizes a safety curtain covering the full height of the door opening to detect passengers or objects.   |
| Next Landing                           | If the elevator doors cannot open fully at the destination floor for any reason, the doors will close and the elevator will proceed to the next floor.  |
| Overload Holding Stop (OLH)            | The elevator buzzer rings to indicate the car is overloaded.  |
| Repeated Door-Close                    | Should an obstacle prevent the doors from closing, the doors will repeatedly open and close until the object is removed.  |
| Emergency Car Lighting (ECL)           | Car lighting turns on immediately when power fails to provide a minimum level of lighting in the car. A choice of either dry-cell battery or trickle-charger battery are available.   |
| Inter Communication System             | A system which allows communication between passengers inside the car and the building personnel.   |
| Emergency Bell                         | In case of an emergency, the bell chime on top of the car is activated by continuously pushing down the bell button indicated on the control panel.   |
| Fire Emergency Return                  | Upon activation of a key switch on the building's fire sensors, all calls are cancelled and all cars immediately return to a specified floor and park there with doors open to ensure safe passenger evacuation.  |

| Standard Features                      | Description  |
|--|--|
| Car Fan Shut Off - Automatic (CFO-A)   | If there is no call within a preset time period, the car fan is automatically shut off to conserve energy.                     |
| Car Light Shut Off - Automatic (CLO-A) | If there is no call within a preset time period, the car light is automatically shut off to conserve energy.                   |
| Car Arrival Chime - Car                | Electronic chime sounds to indicate the car's arrival at the hall. The chime is mounted on the top and bottom part of the car. |

# Technical Specifications

| Optional Features  | Description   |
|--|---|
| Power-On Releveling  | If a car stops at a door zone due to the failure of normal power, the car will relevel to secure the floor level with the doors closed after the normal power has recovered.  |
| Landing Open   | When a car arrives to a hall, the doors will start opening before the car has completely stopped.   |
| Up Peak Service  | Controls the number of cars to be allocated to the main floors, as well as the car allocation timing, in order to meet increased demands for upward travel from the main floors during office starting time, hotel check-in time, etc., and minimize passenger waiting time.      |
| Down Peak Service  | Controls the number of cars to be allocated and the timing of the car allocation in order to meet increased demands for downward travel from the main floors during office leaving time, hotel check-out time, etc., and minimize passenger waiting time.                         |
| Extended Door-Open Operation   | This car button keeps the doors open for an extended period to allow loading of materials, etc.   |
| Main Floor Parking   | An available car always parks on the main floor (GF) with the doors open to reduce passenger waiting time.  |
| Voice Guidance System  | A synthesized voice instructs passengers on the current status, floor number, etc. - english only.  |
| Flashing Hall Lantern  | Hall lanterns flash to indicate the car's arrival and its service direction.  |
| emergency landing device   | upon power failure, a car equipped with this function automatically moves and stops at the nearest floor using a rechargeable battery, and the doors open to ensure passenger safety. this is applicable only when the distance between floors is less than 10 meters.            |
| Fireman's Emergency Operation  | During a fire, when the fireman's switch is activated, the car calls of a specified car and all hall calls are cancelled and the car immediately returns to a pre-determined floor. The car then responds only to car calls which facilitates firefighting and rescue operations. |
| Earthquake Emergency Return (EER-P)  | Upon activation of the primary seismic wave sensors, all cars stop at the nearest floor and park there with the doors open to facilitate safe evacuation of passengers.   |
| Dry contact supply for elevator state signal for BMS - BMS and wiring not provided by mlift. |   |
| Reservation for car card reader - card reader device not provided by mlift.                  |   |
| Reservation for hall card reader - card reader device not provided by mlift.                 |   |
| Reservation for CCTV - camera not provided by mlift.   |   |
| Reservation for loud speakers – loud speakers not provided by mlift.                         |   |

## Layout plan

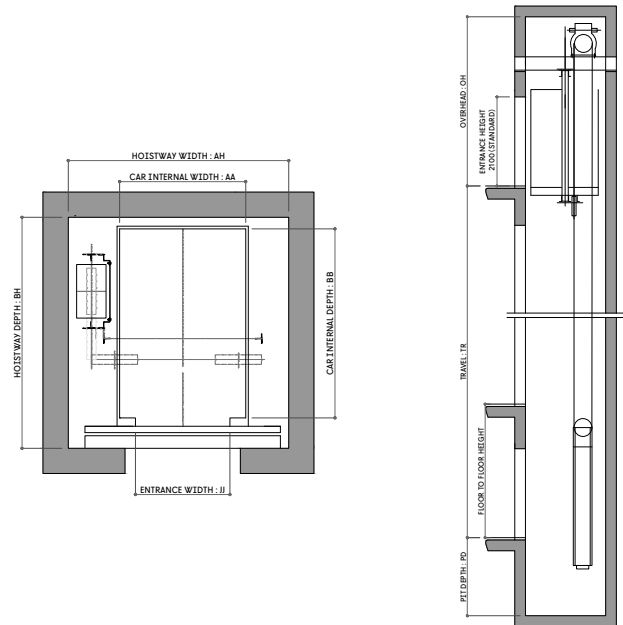

## Application range

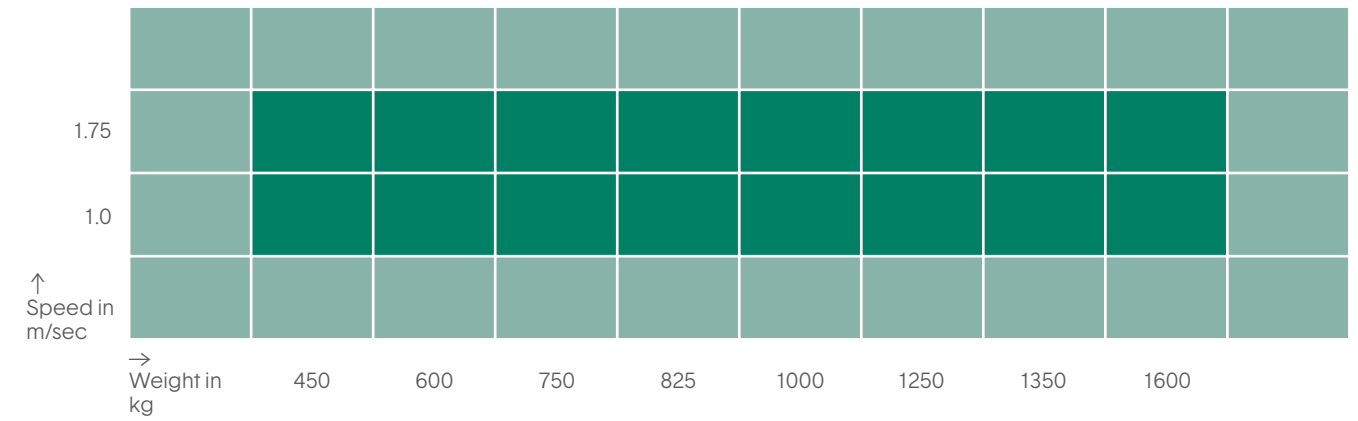

## Technical specifications

The contents of the below table are compliant to standard specifications only. Specifications do not include fireproof landing door and counterweight safety. All information and data are compliant to EN norm.

| No. of persons | Rated speed in m/sec | Rated capacity in Kg | Door type | Entrance dimensions in mm JJ x HH | Car internal dimensions in mm AA x BB x HL | Counterweight position | Minimum hoistway dimensions in mm AH x BH / car | Minimum overhead dimensions in mm OH | Minimum pit depth dimensions in mm PD |
|----------------|----------------------|----------------------|-----------|-----------------------------------|--|------------------------|---|--------------------------------------|---------------------------------------|
| 6              | 1.0<br>1.75          | 450                  | CO        | 800x2100                          | 1200x1000x2300                             | Side                   | 2000x1500                                       | 4200<br>4500                         | 1350<br>1500                          |
| 8              | 1.0<br>1.75          | 600                  | CO        | 800x2100                          | 1100x1400x2300                             | Side                   | 1900x1900                                       | 4200<br>4500                         | 1350<br>1500                          |
| 10             | 1.0<br>1.75          | 750                  | CO        | 800x2100                          | 1400x1300x2300                             | Side                   | 2200x1800                                       | 4200<br>4500                         | 1350<br>1500                          |
| 11             | 1.0<br>1.75          | 825                  | CO        | 800x2100                          | 1400x1400x2300                             | Side                   | 2200x1900                                       | 4200<br>4500                         | 1350<br>1500                          |
| 13             | 1.0<br>1.75          | 1000                 | CO        | 900x2100                          | 1400x1600x2300                             | Side                   | 2500x2100                                       | 4200<br>4500                         | 1350<br>1500                          |
| 16             | 1.0<br>1.75          | 1250                 | CO        | 1000x2100                         | 1400x1900x2300                             | Side                   | 2600x2400                                       | 4500<br>4700                         | 1500<br>1700                          |
| 18             | 1.0<br>1.75          | 1350                 | CO        | 1000x2100                         | 1400x2100x2300                             | Side                   | 2600x2600                                       | 4500<br>4700                         | 1500<br>1700                          |
| 21             | 1.0<br>1.75          | 1600                 | CO        | 1100x2100                         | 1400x2400x2300                             | Side                   | 2800x2900                                       | 4500<br>4700                         | 1500<br>1700                          |

## Layout plan

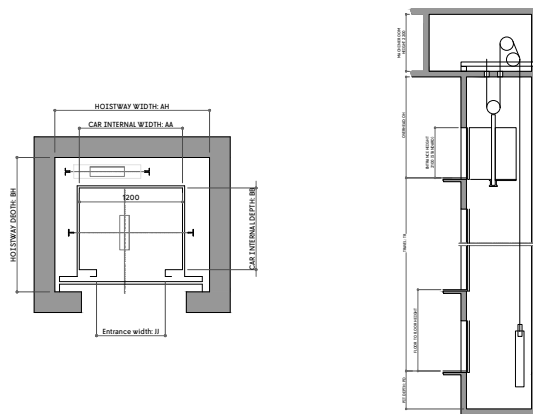

## Application range

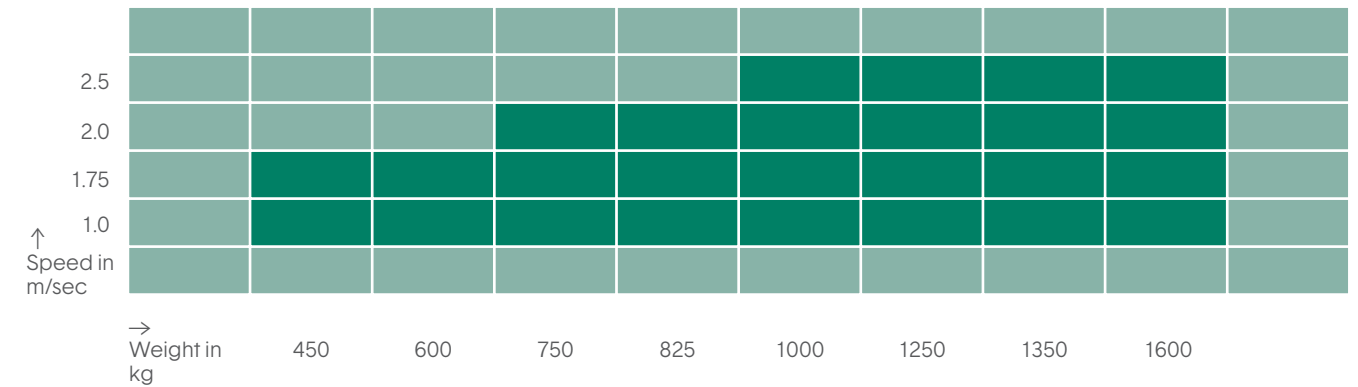

## Technical specifications

The contents of the below table are compliant to standard specifications only. Specifications do not include fireproof landing door and counterweight safety. All information and data are compliant to EN norm.

| No. of persons | Rated speed in m/sec | Rated capacity in Kg | Door type | Entrance dimensions in mm JJ x HH | Car internal dimensions in mm AA x BB x HL | Counterweight position | Minimum hoistway dimensions in mm AH x BH / car | Minimum overhead dimensions in mm OH | Minimum pit depth dimensions in mm PD |
|----------------|----------------------|----------------------|-----------|-----------------------------------|--|------------------------|---|--------------------------------------|---------------------------------------|
| 6              | 1.0                  | 450                  | CO / 2S   | 800x2100                          | 1200x1000x2300                             | Rear / Side            | 1800x1600 / 2000x1600                           | 4400                                 | 1500                                  |
|                | 1.75                 |                      |           |                                   |  |                        |   |                                      | 1500                                  |
| 8              | 1.0                  | 600                  | CO / 2S   | 800x2100                          | 1300x1100x2300 / 1100x1400x2300            | Rear / Side            | 1800x1700 / 1900x1900                           | 4400                                 | 1500                                  |
|                | 1.75                 |                      |           |                                   |  |                        |   |                                      | 1500                                  |
| 10             | 1.0                  | 750                  | CO / 2S   | 800x2100                          | 1300x1400x2300                             | Rear / Side            | 1800x2000 / 2100x1900                           | 4400                                 | 1500                                  |
|                | 1.75                 |                      |           |                                   |  |                        |   |                                      | 1500                                  |
|                | 2.0                  |                      |           |                                   |  |                        |   |                                      | 1800                                  |
| 11             | 1.0                  | 825                  | CO / 2S   | 800x2100                          | 1400x1400x2300                             | Rear / Side            | 1900x2000 / 2200x1900                           | 4400                                 | 1500                                  |
|                | 1.75                 |                      |           |                                   |  |                        |   |                                      | 1500                                  |
|                | 2.0                  |                      |           |                                   |  |                        |   |                                      | 1800                                  |
| 13             | 1.0                  | 1000                 | CO / 2S   | 900x2100                          | 1600x1400x2300 / 1100x2100                 | Rear / Side            | 2100x2000 / 1800x2600                           | 4400                                 | 1500                                  |
|                | 1.75                 |                      |           |                                   |  |                        |   |                                      | 1500                                  |
|                | 2.0                  |                      | CO        | 1600x1400x2300                    | Rear                                       | 2100x2000              | 4900  | 1800                                 |                                       |
|                | 2.5                  |                      |           |                                   |  |                        |   | 2000                                 |                                       |
| 16             | 1.0                  | 1250                 | CO / 2S   | 1000x2100                         | 1800x1500x2300 / 1200x2100                 | Rear / Side            | 2500x2200 / 2200x2600                           | 4400                                 | 1500                                  |
|                | 1.75                 |                      |           |                                   |  |                        |   |                                      | 1500                                  |
|                | 2.0                  |                      | CO        | 1800x1500x2300                    | Rear                                       | 2500x2200              | 4900  | 1800                                 |                                       |
|                | 2.5                  |                      |           |                                   |  |                        |   | 2000                                 |                                       |
| 18             | 1.0                  | 1350                 | CO / 2S   | 1000x2100                         | 1800x1700x2300 / 1300x2200                 | Rear / Side            | 2500x2400 / 2300x2700                           | 4400                                 | 1500                                  |
|                | 1.75                 |                      |           |                                   |  |                        |   |                                      | 1500                                  |
|                | 2.0                  |                      | CO        | 1800x1700x2300                    | Rear                                       | 2500x2400              | 4900  | 1800                                 |                                       |
|                | 2.5                  |                      |           |                                   |  |                        |   | 2000                                 |                                       |
| 21             | 1.0                  | 1600                 | CO / 2S   | 1100x2100                         | 2100x1600x2300 / 1400x2400x2300            | Rear / Side            | 2600x2300 / 2400x2900                           | 4400                                 | 1500                                  |
|                | 1.75                 |                      |           |                                   |  |                        |   |                                      | 1500                                  |
|                | 2.0                  |                      | CO        | 2100x1600x2300                    | Rear                                       | 2600x2300              | 4900  | 1800                                 |                                       |
|                | 2.5                  |                      |           |                                   |  |                        |   | 2000                                 |                                       |

## Layout plan

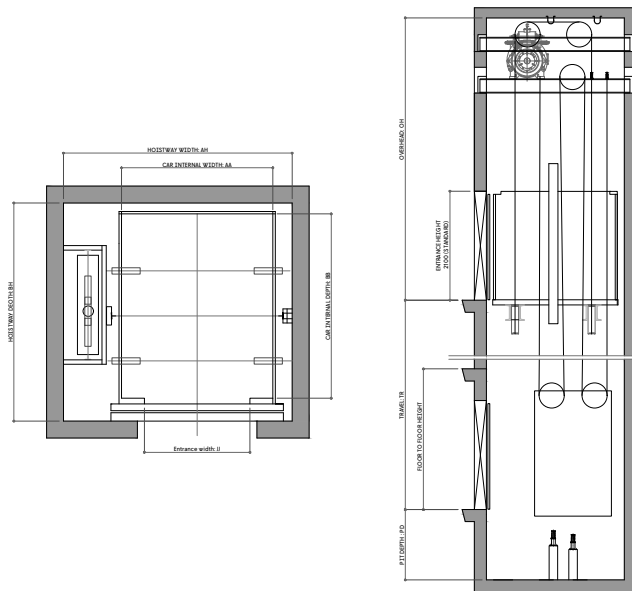

## Application range

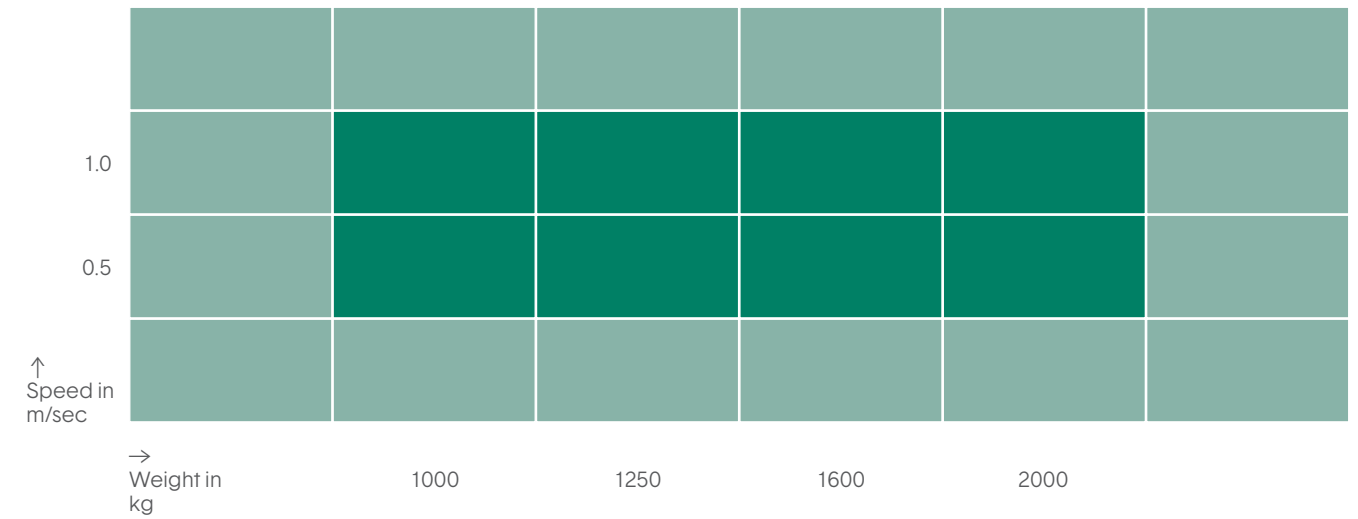

## Technical specifications

The contents of the below table are compliant to standard specifications only. Specifications do not include fireproof landing door and counterweight safety. All information and data are compliant to EN norm.

| No. of persons | Rated speed in m/sec | Rated capacity in Kg | Door type | Entrance dimensions in mm JJ x HH | Car internal dimensions in mm AA x BB x HL | Counterweight position | Minimum hoistway dimensions in mm AH x BH / car | Minimum overhead dimensions in mm OH | Minimum pit depth dimensions in mm PD |
|----------------|----------------------|----------------------|-----------|-----------------------------------|--|------------------------|---|--------------------------------------|---------------------------------------|
| 0.5<br>1.0     | 1000                 | CO                   | 900x2100  | 1600x1400x2300                    | Side                                       | 2400x1800              | 4600<br>4800                                    | 1600<br>1700                         |                                       |
| 0.5<br>1.0     | 1250                 | CO                   | 1000x2100 | 1800x1500x2300                    | Side                                       | 3000x2100              | 4600<br>4800                                    | 1600<br>1700                         |                                       |
| 0.5<br>1.0     | 1600                 | CO                   | 1100x2100 | 1400x2400x2300                    | Side                                       | 2700x2900              | 4600<br>4800                                    | 1600<br>1700                         |                                       |
| 0.5<br>1.0     | 2000                 | CO                   | 1700x2100 | 1700x2400x2300                    | Side                                       | 3000x2900              | 4800<br>5000                                    | 1700<br>1800                         |                                       |

## Layout plan

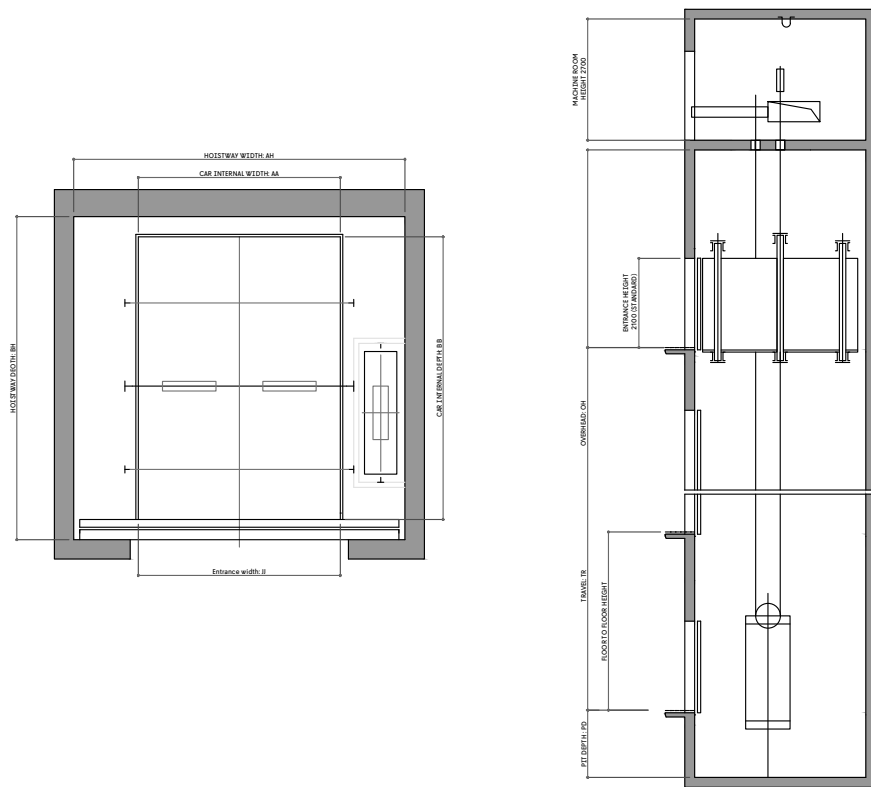

## Application range

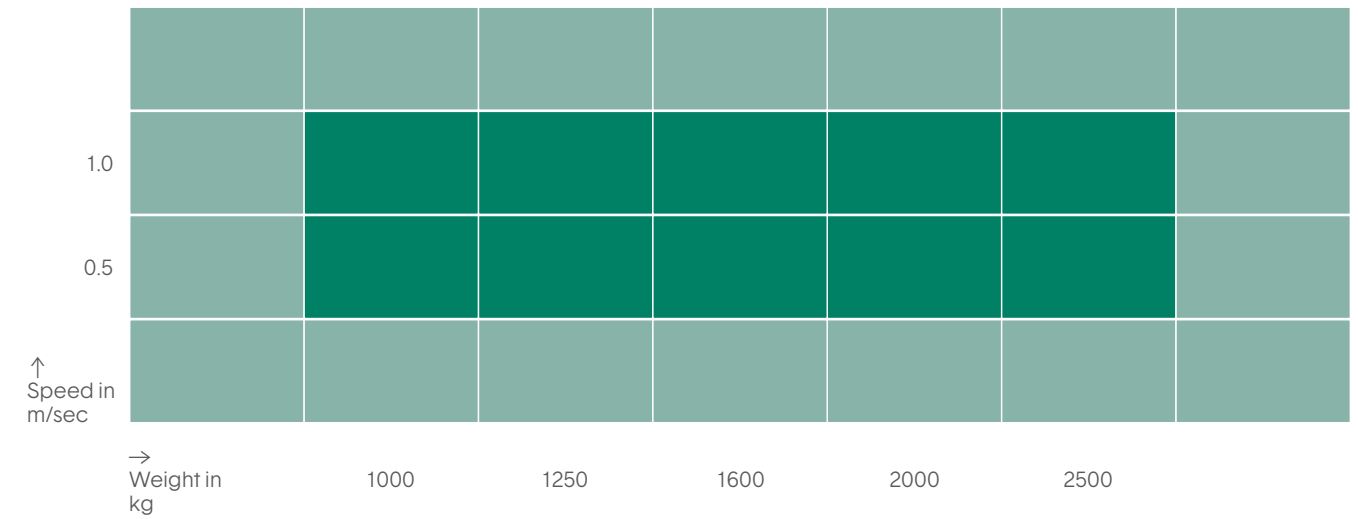

## Technical specifications

The contents of the below table are compliant to standard specifications only. Specifications do not include fireproof landing door and counterweight safety. All information and data are compliant to EN norm. \*In the event where the capacity of a freight elevator is in excess of 2500Kg, please refer to our technical department for further information and guidance.

| No. of persons | Rated speed in m/sec | Rated capacity in Kg | Door type | Entrance dimensions in mm JJ x HH | Car internal dimensions in mm AA x BB x HL | Counterweight position | Minimum hoistway dimensions in mm AH x BH / car | Minimum overhead dimensions in mm OH | Minimum pit depth dimensions in mm PD |
|----------------|----------------------|----------------------|-----------|-----------------------------------|--|------------------------|---|--------------------------------------|---------------------------------------|
|                | 0.5                  | 1000                 | CO        | 900x2100                          | 1600x1400x2300                             | Side                   | 2400x1900                                       | 4600                                 | 1600                                  |
|                | 1.0                  |                      |           |                                   |  |                        |   |                                      |                                       |
|                | 0.5                  | 1250                 | CO        | 1000x2100                         | 1800x1500x2300                             | Side                   | 2600x2000                                       | 4600                                 | 1600                                  |
|                | 1.0                  |                      |           |                                   |  |                        |   |                                      |                                       |
|                | 0.5                  | 1600                 | CO        | 1100x2100                         | 1400x2400x2300                             | Side                   | 2500x2900                                       | 4600                                 | 1600                                  |
|                | 1.0                  |                      |           |                                   |  |                        |   |                                      |                                       |
|                | 0.5                  | 2000                 | CO        | 1700x2100                         | 1700x2400x2300                             | Side                   | 3000x2900                                       | 4600                                 | 1600                                  |
|                | 1.0                  |                      |           |                                   |  |                        |   |                                      |                                       |
|                | 0.5                  | 2500                 | CO        | 1700x2100                         | 1700x2800x2300                             | Side                   | 3100x3300                                       | 4600                                 | 1600                                  |
|                | 1.0                  |                      |           |                                   |  |                        |   |                                      |                                       |

A dialogue between architecture,  
design and know-how.



