

mlift

ELEVATOR CABIN DESIGN

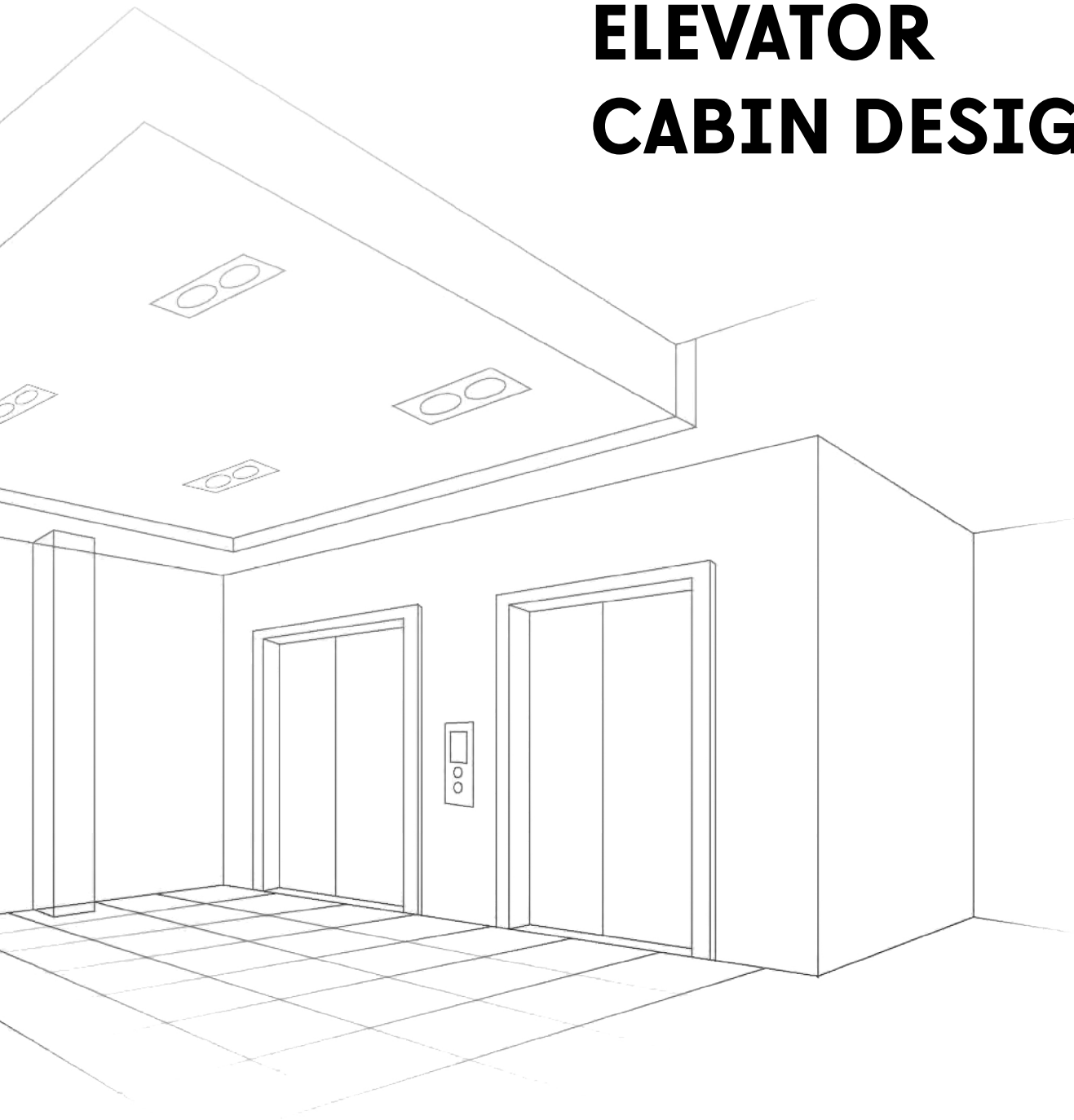

**Al Masar el Sarie
for Elevators & General Contracting
SARL (mlift)**

**Management:
964 07825334422**

info@mliftgroup.me

**Mlift House, 2th Floor
Al Karada Kharej, Main Road
Street 175 – M 909
No. A Building 180**

www.mliftgroup.me

Introducing **mlift**, an exclusive
and refined line of elevator systems.

mlift brings human alchemy
and sophisticated skill together
to create elevators with subtle
elegance and timeless design.

Simplicity in form and function is
what makes **mlift** a level above the rest.



▲ D1 7908

Ceiling: Wooden frame, LED downlight, light band

Car wall: Rear wall wooden decoration and mirror; two side walls wooden decoration; wooden kickplate; front wall wooden decoration

Handrail: None

Floor: Marble



D17950

Ceiling: Mirror st.st. frame, acrylic light decoration

Car wall: Rear wall central panel mirror st.st., auxiliary panel and side walls wood decoration, front wall hairline st.st., three sides car wall hairline st.st. kickplate

Handrail: None

Floor: PVC



D18981

Ceiling: Diamond silver painted steel plate, acrylic, downlight
Car wall: Rear wall central panel mirror st.st. and hairline
st.st. bar insert, two side walls central panel mirror st.st.,
three sides car wall auxiliary panel wood makeup steel plate,
front wall mirror st.st.
Handrail: None
Floor: PVC



D17026

Ceiling: Bronze-painted hairline st.st. for the old, downlight, hidden light band

Car wall: Rear wall central panel linen wallpaper, Bronze-painted hairline st.st. for the old frame, hidden light, arc shape at the corner, the rest bronze-painted hairline st.st. for the old

Handrail: Bronze-painted hairline st.st. for the old handrail

Floor: Marble



▲ D17627

Ceiling: Hairline st.st. frame with downlight
Car wall: Rear wall central panel mirror st.st.,
auxiliary panel Ti-black hairline st.st., two
side walls Ti-black hairline st.st., front wall
Ti-black hairline st.st.
Handrail: Hairline st.st. round handrail
Floor: Marble



▲ D18679

Ceiling: Ti-black hairline st.st., LED straight light, LED downlight

Car wall : Rear wall Ti-black mirror st.st., two side walls Ti-black hairline st.st., LED light strip, front wall Ti-black hairline st.st.

Handrail:None

Floor: Marble



▲ **D17619**

Ceiling: Ti-black mirror st.st.,
downlight
Car wall: Ti-black mirror st.st.,
green ground glass, UV kickplate
Handrail: Ti-black flat handrail
Floor: Marble

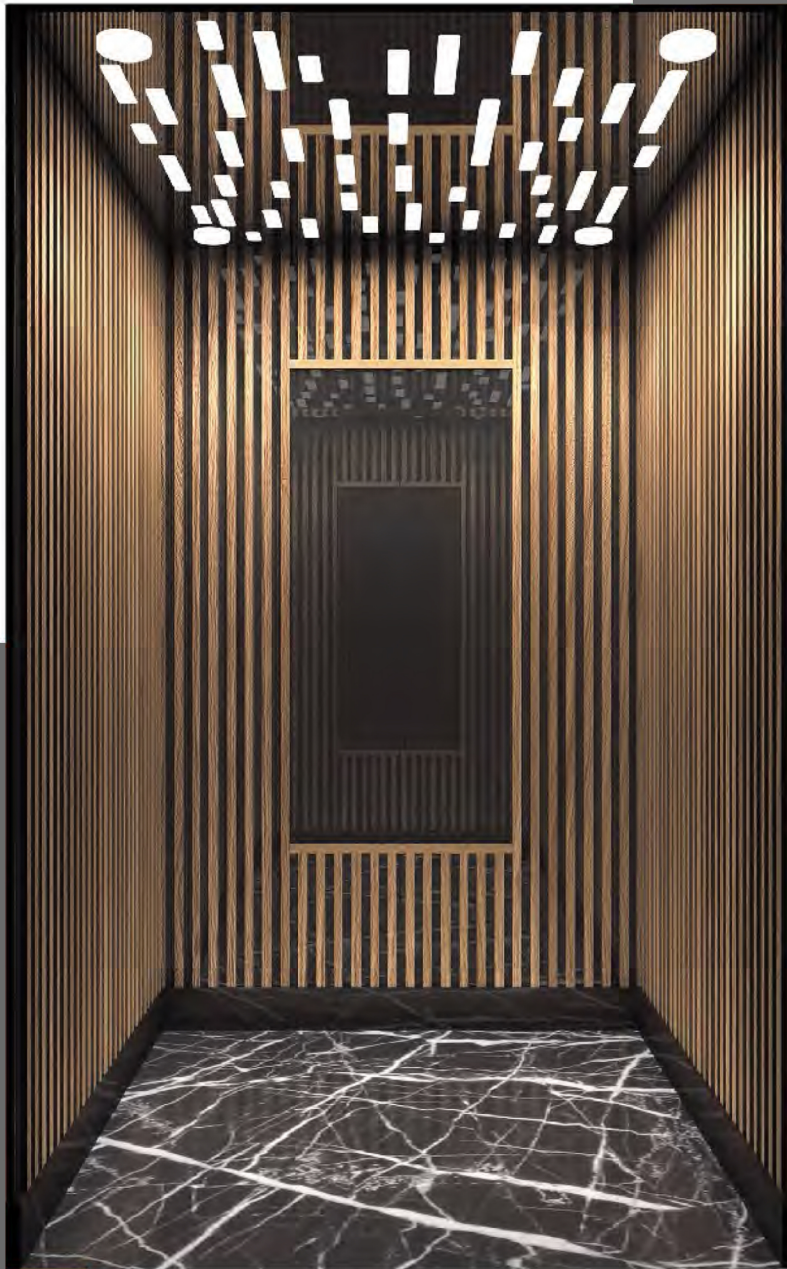

▲ D17958

Ceiling: Art light, mirror st.st., acrylic transparent light decoration
Car wall: Three sides car wall mirror st.st., wooden decoration; mirror st.st.
kickplate, front wall mirror st.st.
Handrail: None
Floor: Marble



▲ D18980

Ceiling: Middle U-shaped hairline bottom plate with light bar, downlights on both sides

Car wall: Three sides car wall central panel Ti-black mirror st.st., auxiliary panel wood decoration, front wall Ti-black mirror st.st.

Handrail: None

Floor: Marble

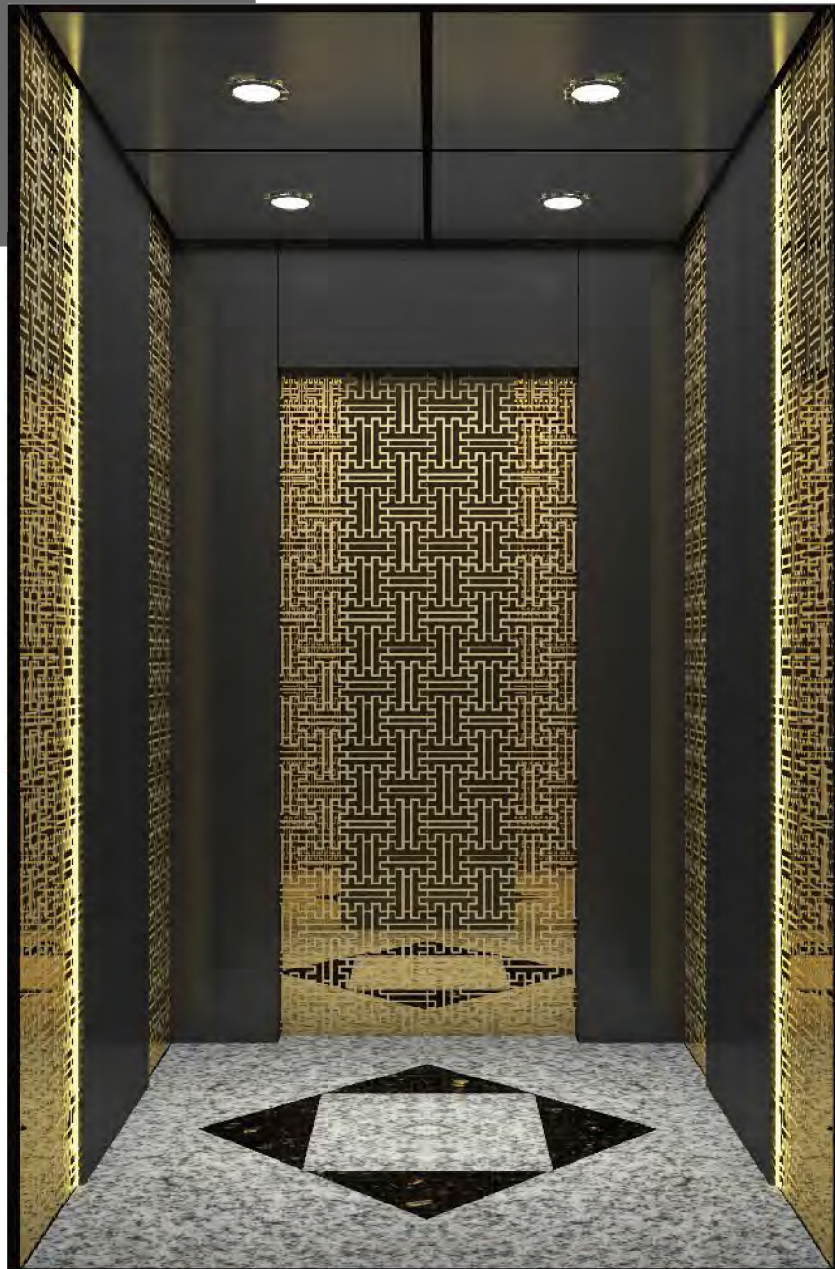

▲ D17711

Ceiling: Ti-black mirror st.st. frame with downlight
Car wall: Rear wall central panel Ti-gold mirror etched st.st., auxiliary panel Ti-black hairline st.st.; two side walls central panel Ti-black hairline st.st., auxiliary panel Ti-gold mirror etched st.st., soft light between central panel and auxiliary panel, Front wall Ti-gold mirror etched st.st.

Handrail : None

Floor: PVC

A dialogue between architecture,
design and know-how.

